

Walk In Cooler Applications Heavy Cart to Light Motorized Traffic



DOUBLE ACTING ENERGY DOOR

- SELF CLOSING HARDWARE
- R25+
- VAPOR BARRIER
- FULL PERIMETER THERMAL BREAK
- DUAL GASKET
- TRIPLE PANE WINDOW GAS FILLED



NATIONAL ACCESS DESIGN, LLC doors are available in single or double panel.

FEATURES:

- 4" overall thickness.
- Hinges are V-CAM assembly with 10" jamb guards.
- Standard windows are triple pane, gas filled 14" x 14" x 1/4" glass with a full thermal break. Window frame comes standard with a satin anodized aluminum finish.
- Available standard colors are black, royal blue, canyon blue, green, brown, white, beige, dark gray, light gray and red.
- Doors can be manufactured to fit up to an 8' x 8' opening.

Consult factory for larger openings.

National Access Design, LLC

phone: 513-351-3400 • fax: 866-300-4539

sales@nationalaccessdesign.com • 1871 Summit Road • Cincinnati, Ohio 45237

ARCHITECTURAL SPECIFICATIONS

Where indicated on plans, furnish Energy Door double acting, gravity actuated traffic door as manufactured by National Access Design LLC, Cincinnati, Ohio. Doors will be constructed with a non-CFC urethane core complete with vapor barrier. Overall thickness is 4". Windows are triple pane gas filled 14" x 14" x 1/4" glass set in a satin anodized aluminum frame. The facing is high impact plastic. Doors are fully gasketed. Hardware to be V-Cam assembly with 10" Jamb Guards.

To fit door opening size:

_____ width x _____ height

- Single
- Bi-Parting

OPTIONS:

Teardrop Bumpers, Impact Plates and Jamb Guards, are available as upgrades. 10" Jamb Guards (STND)

TEARDROP BUMPERS (BOTH SIDES)

- FB12 (12")
- FB18 (18")
- FB24 (24")
- FB30 (30")
- FB36 (36")
- FB42 (42")
- FB48 (48")

IMPACT PLATES (BOTH SIDES)

BLACK ABS (STND)

- PL12 (12")
- PL18 (24")
- PL24 (24")
- PL30" (30")
- PL 36 (36")
- PL42 (42")
- PL48 (48")

WINDOWS CONSULT FACTORY

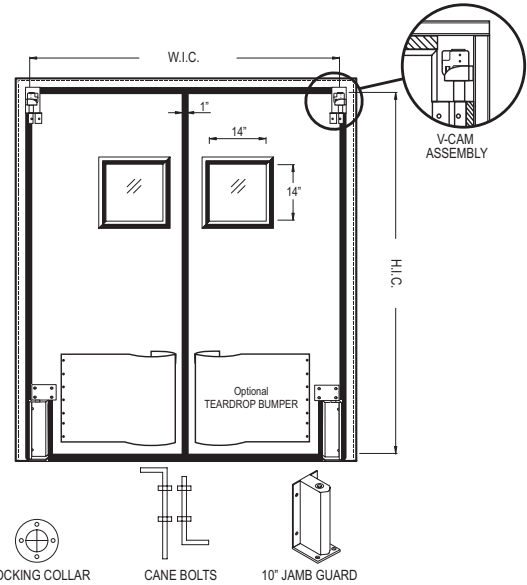

THERMOPLASTIC FACINGS COLOR OPTIONS

- BLACK
- WHITE
- BROWN
- BEIGE
- CANYON BLUE
- GREEN
- LT. GRAY
- DK. GRAY
- RED

OTHER

- LIMITING POSTS
- CANE BOLTS
- LOCKING COLLARS
- RUB RAILS
- SS JAMB GUARD - JG-10 (10")
- JAMB GUARD - JG-18 (18")
- TRANSOM PANELS FOR OPENINGS OVER 8' HIGH
- WASH DOWN PACKAGE TO SEAL ALL VOIDS
- TUBE STYLE FRAME - POWDER COATED STEEL
- TUBE STYLE FRAME - STAINLESS STEEL
- C-CHANNEL FRAME - POWDER COATED STEEL
- C-CHANNEL FRAME - STAINLESS STEEL



Energy Doors are shipped FOB Factory.

Customer: _____

Approved By: _____ Date: _____