

DOUBLE ACTING "INSULATED" ENERGY TRAFFIC DOOR

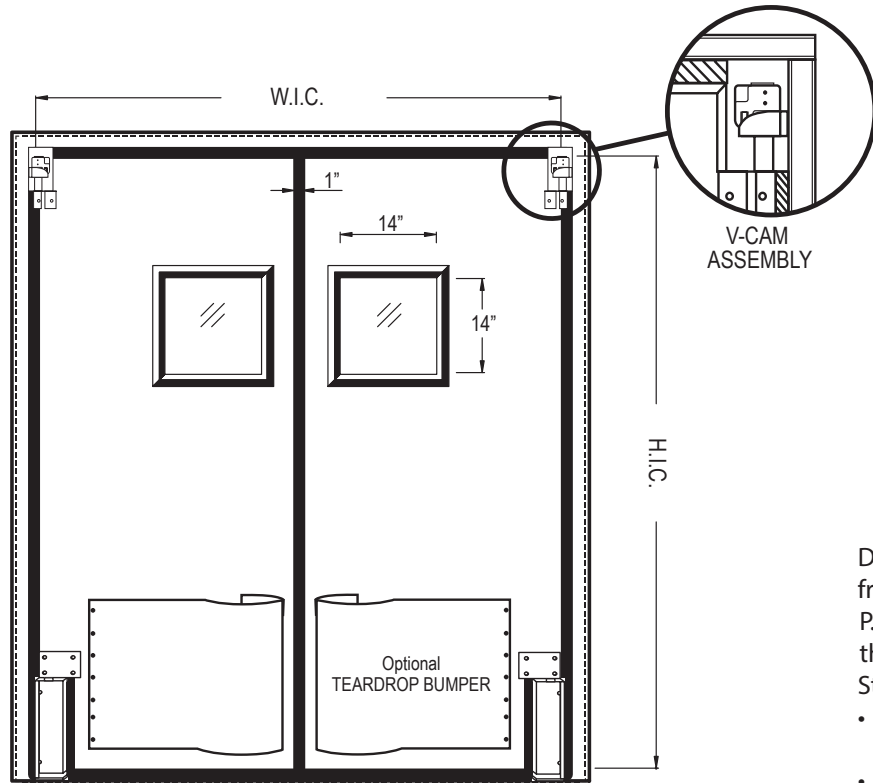

V-CAM ASSEMBLY

- Doors to be constructed from a custom rigid P.V.C. extrusion with thermo-plastic facings. Standard features are:
- V-Cam Hinge with bottom 10" Jamb Guard.
 - 14"x14" x 1/4" or 10" x 30" 1/4" triple pane gas filled glass window in satin anodized aluminum frame.
 - Fully insulated R 25+
 - 4 1/4" Overall thickness



LOCKING COLLAR

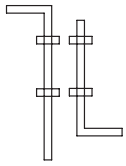

CANE BOLTS

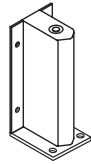

10" JAMB GUARD

National ACCESS DESIGN LLC
 513-351-3400 fax: 866-300-4539 sales@nationalaccessdesign.com
 NationalAccessDesign.com

DOOR SPECIFICATION

Opening Width _____ x Height _____

Qty. _____

- BI-PARTING SINGLE PANEL
 L R

THERMOPLASTIC FACINGS COLOR OPTIONS

- BLACK WHITE BROWN
 BEIGE RED GREEN
 LT. GRAY DK. GRAY
 CANYON BLUE

TEARDROP BUMPER

- FB12" FB18" FB24" FB30"
 FB36" FB42" FB48"

IMPACT PLATES (BLACK ABS STANDARD)

- PL12" PL18" PL24"
 PL30" PL36" PL42"
 PL48"

HARDWARE OPTIONS

- CANE BOLTS
 LOCKING COLLARS

WINDOW OPTIONS

- 14" x 14" x 1/4"
 10" x 30" x 1/4"

Charges will be assumed by buyer for changes or cancellations to work in process. Buyer hereby accepts responsibility for all sizes and dimensions. This order will not be processed until all acknowledgement forms are signed and returned.

Specification accepted by: _____

Date: _____

NAD ENERGY DOOR

JOB NAME/LOCATION

CUSTOMER/LOCATION

CUST. ORDER NO.

CUST. PO ORDER NO.